

TREE PRESERVATION PRIVATE PROPERTY TREES

Roots of trees extend far beyond the tree's canopy. To protect these roots place construction fencing around the DRIPZONE (see diagram) of the tree, OR as far out from the trunk as possible.

The impact of construction on your tree will largely be determined by the amount of space given for the tree protection area. The greater the space, the better chance for survival of your tree during construction.

Dotted line shows construction fence perimeters, the X denotes metal poles to be placed every 10'. This will ensure stability through the construction process.

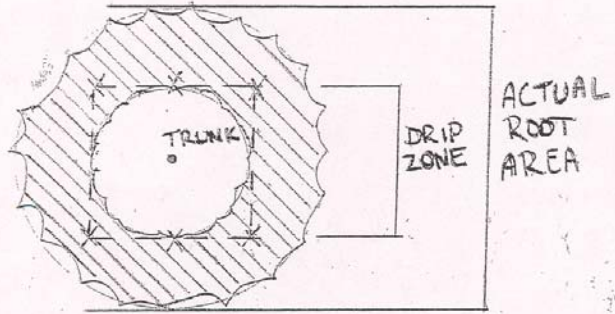

PARKWAY TREES

Generally the root system of a parkway tree only extends from the trunk to the end of the parkway on the street side of the tree. The roots on the sidewalk side can run underneath the walkway and onto private property. IT IS VERY IMPORTANT TO FENCE OFF THE ENTIRE PARKWAY to minimize the damage to the root system of these trees. Please refer to the diagram for the proper installation of parkway tree fencing.

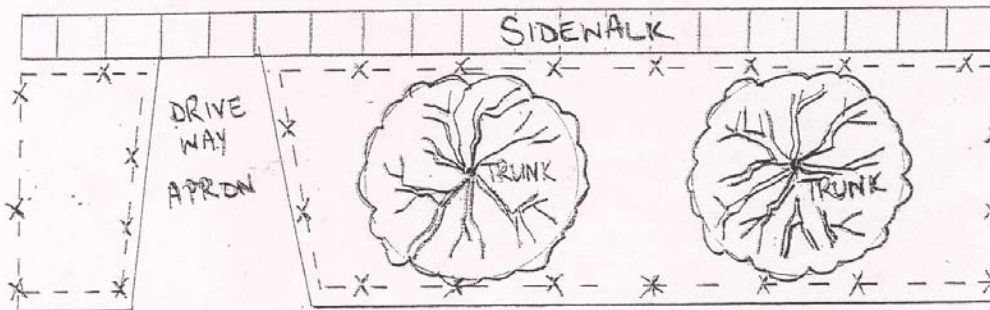

Dotted line shows construction fence perimeters, the X denotes metal poles to be placed every 10'. This will ensure stability through the construction process.

PARKWAY TREE FENCING WITHOUT DRIVEWAY

Certain sites do not have access to the front of the property for various types of construction activity. If the property **DOES NOT** have a driveway for access The City Of Park Ridge will allow a **10 FOOT** access point to the front of the property across the parkway. This access point must be properly constructed to protect the roots of the parkway trees from compaction by heavy equipment or other construction damage. The general contractor or owner must fence off the perimeter of the parkway up to the designated access point. Plywood or a minimum of 10" of wood chips must be placed across the entire 10' wide access point. This must be **MAINTAINED DAILY** for the duration of the construction activity.

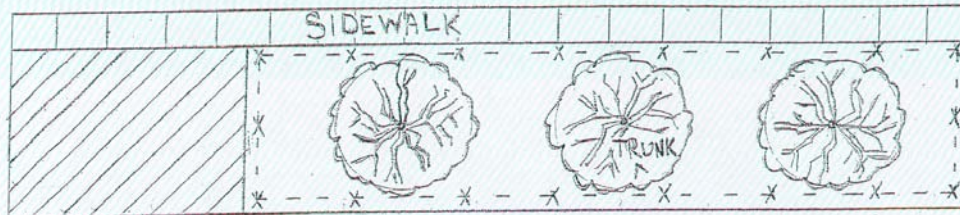

10' access point, woodchips or plywood to cover entirely, ---X--- denotes fencing

CONSTRUCTION DANGERS TO BE AWARE OF

COMPACTION: Minimize this type of damage by fencing trees to the DRIPZONE. Roots are located in the top 6-12" of soil. They are the vital support structure and water/nutrient provider for the tree. Large equipment (bobcats, loaders, cement trucks, etc.), if driven over this area, will reduce the pore space in the soil. There will be less water and oxygen available in the soil because of this activity. This will cause the tree to "starve" since it's roots will be damaged and not able to access the water and nutrients they need.

TRUNK DAMAGE/BROKEN BRANCHES: Prevent this damage by pruning low hanging branches on construction sites to avoid breaking & ripping them with trucks and other construction equipment. If there are low hanging branches on parkway trees contact the Forestry Division at 847-318-5451. We will have them pruned for your project. Installation and maintaining tree protection fencing will keep skidders, bobcats, etc. from damaging the trunk. Wounds caused in this manner leave sources of infection for pathogens. This will cause the tree to be stressed and susceptible to disease and death.

TRENCHING: Sewer, water and other utilities are placed underground. The installation of these lines within the dripzone of the tree via trenching causes tremendous damage to the root system of the tree. The machines will tear & sever a large portion of the root zone responsible for water & nutrient uptake. This will provide a source of infection for fungus & other pathogens leading once again to tree stress, disease problems, weak limbs, and death. **CONTRACTORS MUST USE TREE AUGERING SPECS PROVIDED BY THE MUNICIPAL FORESTERS OF NORTHEAST ILLINOIS.**

PLEASE NOTE:

OTHER MEASURES MAY BE USED TO PROTECT TREES DURING THE CONSTRUCTION PROCESS.

THESE METHODS WILL BE WRITTEN ON THE PERMIT.